

ARK-1123L A3

Intel® Atom™ E3825 SoC with Dual COM and GPIO Palm-Size Fanless Box PC



Features

- Intel® Atom™ Processor E3825 Dual Core 1.33 GHz SoC
- 1 x 2.5" SATA HDD/SSD Bay
- 1 x GbE & 1 x VGA & 1 x GPIO
- 1 x RS-232 & 1 x RS-232/422/485
- 1 x Full-Size MiniPCIe (ex. WLAN or WWAN module) #1
- 1 x Half Size MiniPCIe (ex. mSATA)
- Optional VESA / DIN Rail / Wall Mounting kits
- Threaded DC jack design
- Supports WISE-DeviceOn and Embedded Software APIs



Specifications

| | | ARK-1123L-S3A3 |
|-------------------|----------------------------|--|
| Processor System | CPU | Intel® Atom™ E3825 Dual Core SoC |
| | Frequency | 1.33 GHz |
| | L2 Cache | 1 MB |
| | BIOS | AMI EFI 64 Mbit (Default BIOS is supported for 64-bit OS installation, BIOS for 32-bit OS is supported by project) |
| Memory | Technology | DDR3L 1066MHz |
| | Max. Capacity | 8 GB |
| | Socket | 1 x 204-pin SO-DIMM |
| Graphics | Chipset | Intel® Atom™ SoC integrated |
| | Graphic Engine | DirectX* 11.1, OGL 3.0, OCL 1.1, OGL ES 2.0 support Encode: H264, MPEG2/4, VC1, WMV9 Decode: H264, MPEG2 |
| | VGA | 1 x VGA, support up to 1920 x 1200 at 60Hz |
| Audio | Main System | ALC-888S, High Definition Audio. Line-out & Line-in |
| Ethernet | LAN #1 | 10/100/1000 Mbps Intel I210 GbE, support Wake on LAN |
| I/O Interface | Serial Ports | 1 x RS-232 & 1 x RS-232/422/485 (BIOS selectable) |
| | USB Interface | 1 x USB 2.0 & 1 x USB3.0 |
| Other | Watchdog timer | 255-level timer interval, setup by software |
| | GPIO | 8 bit GPIO |
| Expansion | Mini PCIe | 1 x Full-size Mini PCIe, support WLAN or WWAN module #1 |
| | 2.5" Drive Bay | 1 x 2.5" SATA HDD Bay (Max Height 9.5mm) |
| Storage | mSATA | 1 x Half-size mSATA |
| | Microsoft Windows | WES7, Windows 7, WE8S, Windows 8 and Windows 10 |
| Software Support | Linux | Support (by Project) |
| | Power Input Voltage | 12 V _{oc} |
| Power Requirement | Power Adapter | AC to DC, DC12 V/3 A, 36 W with threaded design |
| | Typical | 5.28W |
| | Max. | 8.16W |
| Power Consumption | Construction | Aluminum housing |
| | Mounting | VESA/DIN Rail/Wall Mounting Kits (Optional) |
| | Dimensions (W x H x D) | 133.8 x 43.1 x 94.2 mm (5.27" x 1.7" x 3.71") |
| | Weight | 0.8kg |
| Mechanical | Operating Temperature | With extended temperature SSD/mSATA/RAM : -30 ~ 70° C with 0.7m/s air flow With standard temperature HDD/SSD/mSATA/RAM peripherals:0 ~ 40° C with 0.7m/s air flow |
| | Storage Temperature | -40 ~ 85° C (-40~185° F) |
| | Relative Humidity | 95% @ 40° C (non-condensing) |
| | Vibration During Operation | With mSATA/SSD: 3 Grms, IEC 60068-2-64, random, 5 ~ 500 Hz, 1 hr/axis With HDD: 0.5Grms, IEC 60068-2-64, random, 5~500Hz, 3 axes, 1hr/axis |
| | Shock During Operation | With mSATA/SSD: 30 G, IEC 60068-2-27, half sine, 11 ms duration With HDD: 10G, IEC 60068-2-27, half sine, 11 ms duration |
| Regulation | EMC | CE/FCC Class A, CCC, BSMI |
| | Safety | UL, CCC, BSMI, CB |

#1 Mini PCIe slot is hardware interface for wireless communication integration only. System level RF certification is not available.

Dimensions

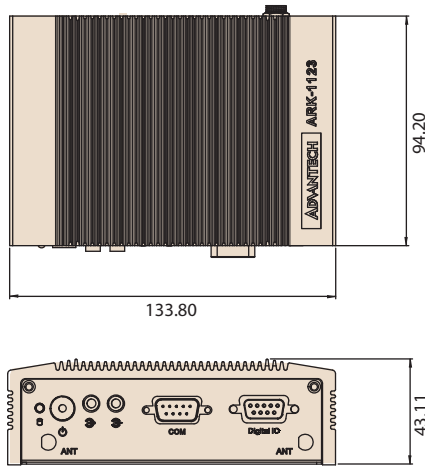

DIN Rail

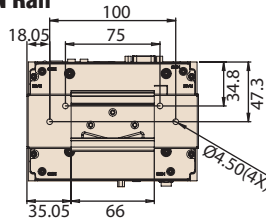

Unit: mm

VESA mount

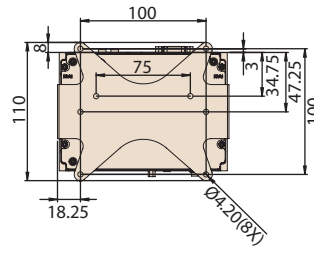

Wall mount

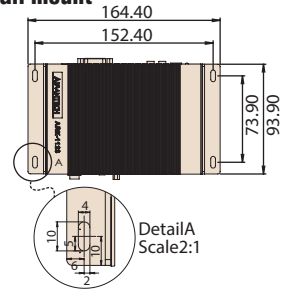

Front Panel External I/O Mechanical Layout/Drawing

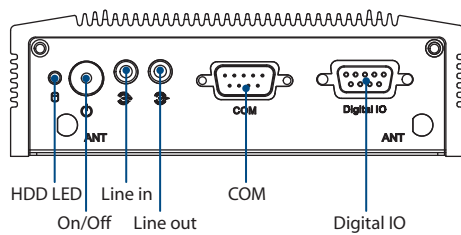

Rear Panel External I/O Mechanical Layout/Drawing

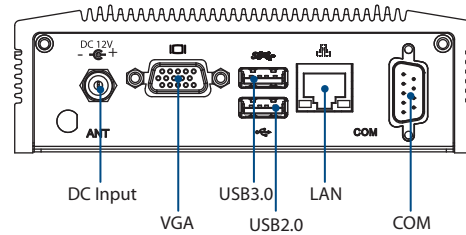

Ordering Information

| Part Number | Intel CPU | RAM | VGA | GbE | USB 2.0 | USB 3.0 | RS-232 | RS-232/422/485 | GPIO | Audio | MiniPCIe | 2.5" HDD bay | mSATA | Operating Temperature |
|----------------|------------------|-----------|-----|-----|---------|---------|--------|----------------|------|---------------------|-------------|--------------|---------|-----------------------|
| ARK-1123L-S3A3 | Intel Atom E3825 | Up to 8GB | 1 | 1 | 1 | 1 | 1 | 1 | 1 | Line in Line out | 1 Full size | 1 | 1 (H/S) | -30 ~ 70° C |

Note: Memory, storage and operating system bundled by request.

Packing List

| Part Number | Description |
|------------------|---|
| - | 1 x ARK-1123L Unit |
| - | 1 x User Manual (Simplified Chinese) |
| 96PSA-A36W12W7-5 | 1 x AC to DC adapter DC 12V/3A 36W, -20 ~ 60° C |

Embedded OS (Only available for T-Parts OEM, and CTOS service)

| Part Number | Description |
|----------------|---|
| 2070013031 | WE7E 64-bit with EN/JP/TC/SC (OS size around 11G) |
| 2070013369 | WE8S 64-bit with EN/JP/TC/SC (OS size around 13G) |
| 20706WX9ES0090 | img W10 19EL ARK-1123L 64b 1809 ENU (OS size around 16.5GB) |

Optional Items

| Part Number | Description |
|-------------|---------------------------------------|
| 1700001524 | Power Cable 3-pin 180cm, USA type |
| 170203183C | Power Cable 3-pin 180cm, Europe type |
| 170203180A | Power Cable 3-pin 180cm, UK type |
| 1700008921 | Power Cable 3-pin PSE Mark 183cm |
| AMK-V003E | ARK-112X series VESA mounting kit |
| AMK-R001E | ARK-112X series DIN-rail mounting kit |
| AMK-W001E | ARK-112X series Wall mounting kit |

Online Download www.advantech.com/products

