

# Battery Rack

The cylindrical convex plate is welded above the support, and the bottom hole is opened. purpose :1. Positioning between each layer of support; 2. M10 expansion bolts can be used to secure the support at the bottom.

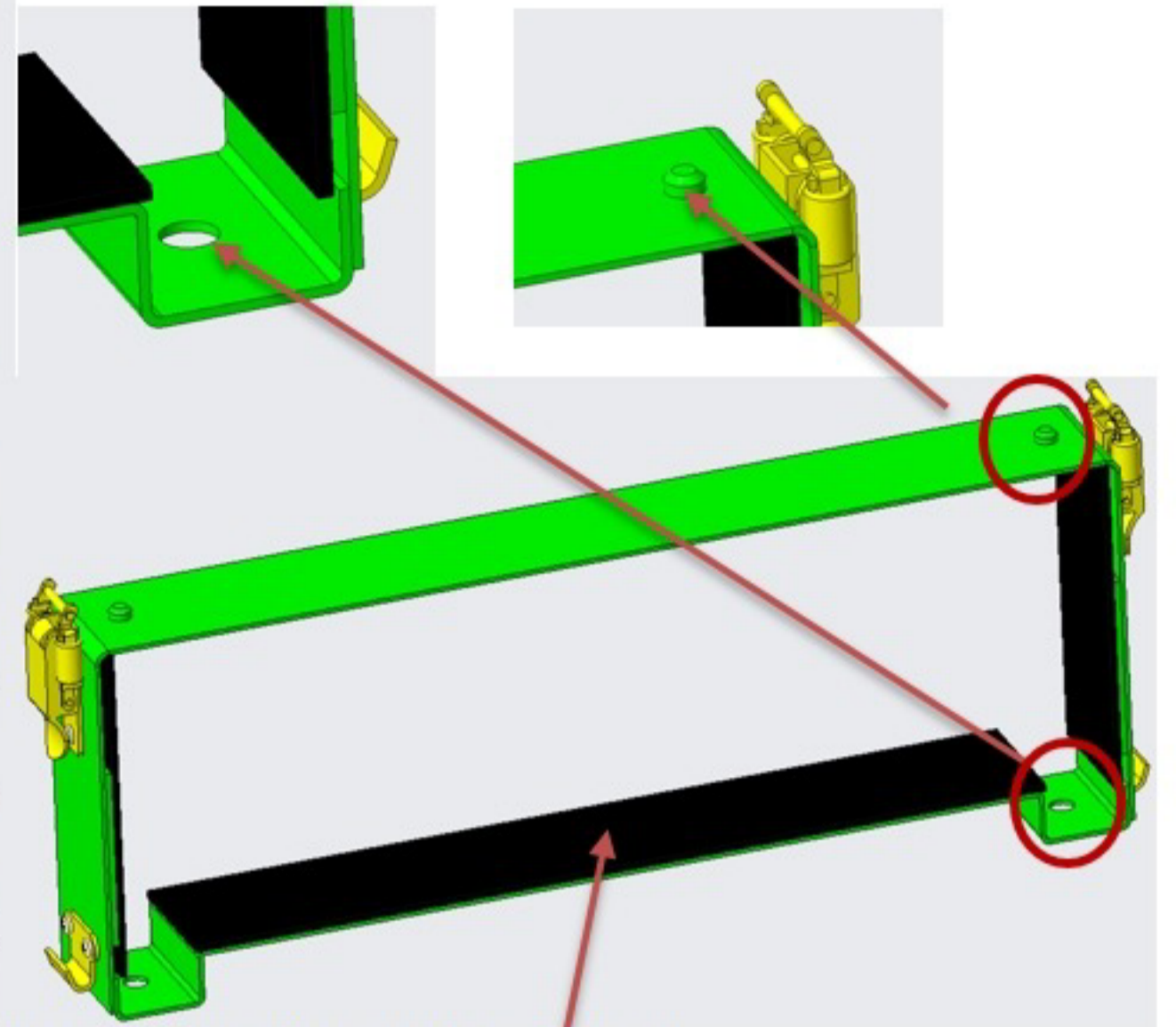

DKD-2 spring buckle, material :304 stainless steel

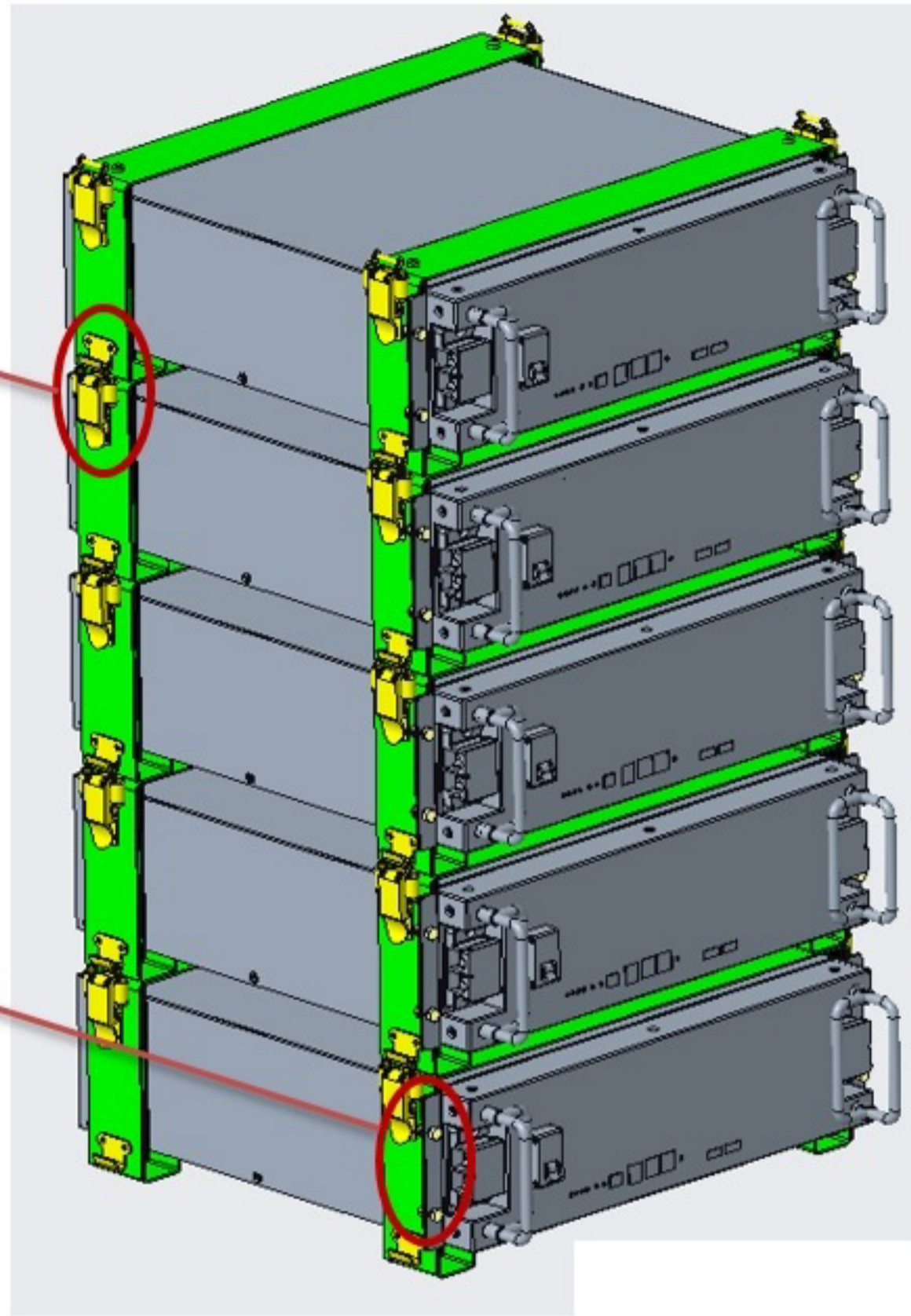
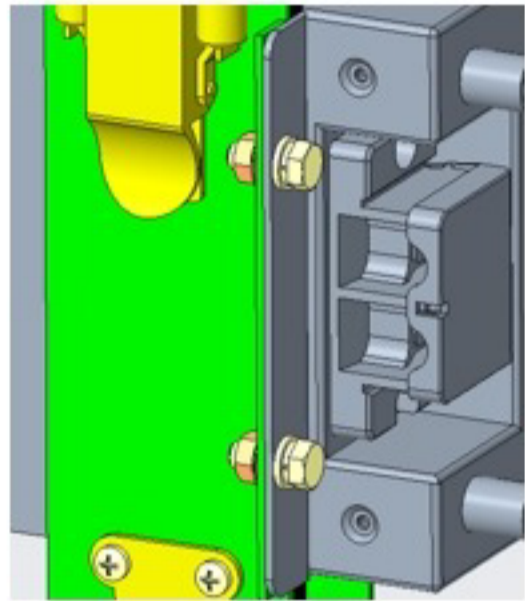
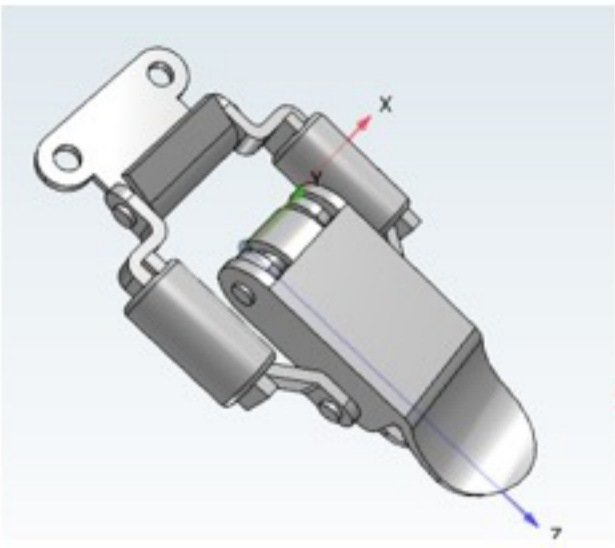

The battery is secured with M6\*16 cross totem screws.

The contact surface with the battery is pasted with CR rubber pad to prevent battery scratches and insulation

## Dimensions (3U)

### battery bracket-1 (weight : 2.8kg)

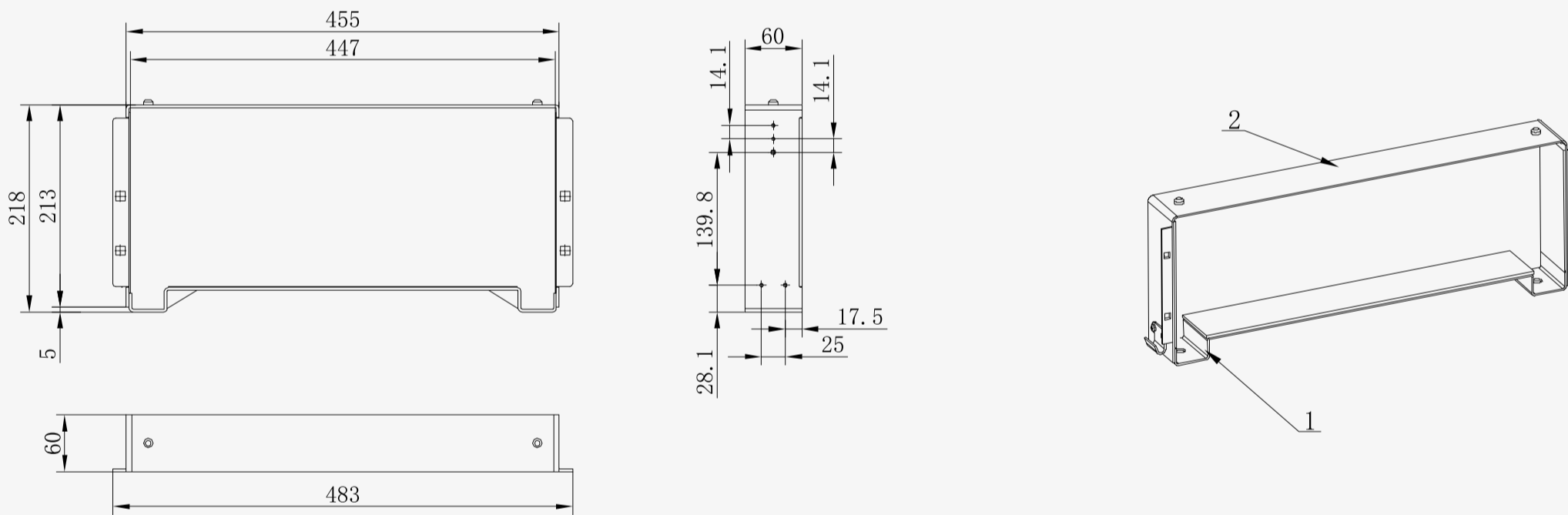

### battery bracket-2 (weight : 2.5kg)

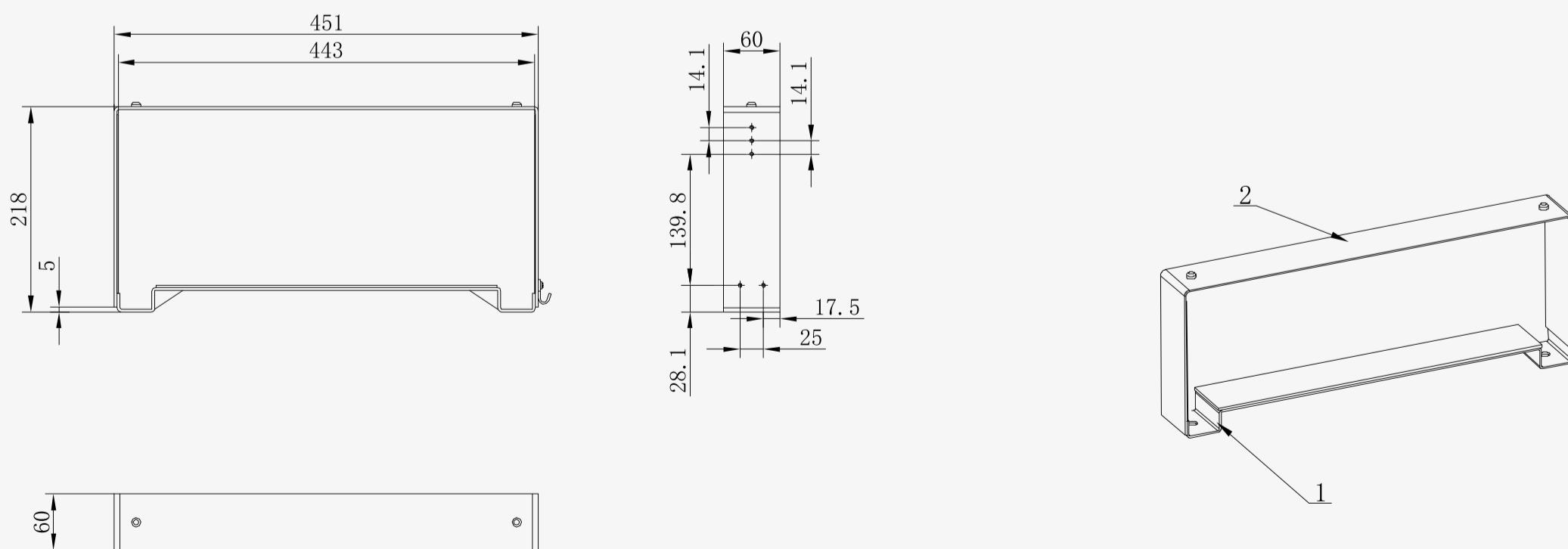

Contacto:  
baires@tempelgroup.com  
www.tempelgroup.com  
Tel. +54 11 2734 8961

TEMPEL GROUP en el mundo  
BARCELONA - BUENOS AIRES - MADRID - VALENCIA - BILBAO - SEVILLA - LISBOA - PORTO - LIMA - SÃO PAULO - SANTIAGO DE CHILE - BOGOTÁ - CIUDAD DE MÉXICO - CIUDAD DE PANAMÁ - MONTEVIDEO - QUITO - HOUSTON - ROMA - ASUNCIÓN

